

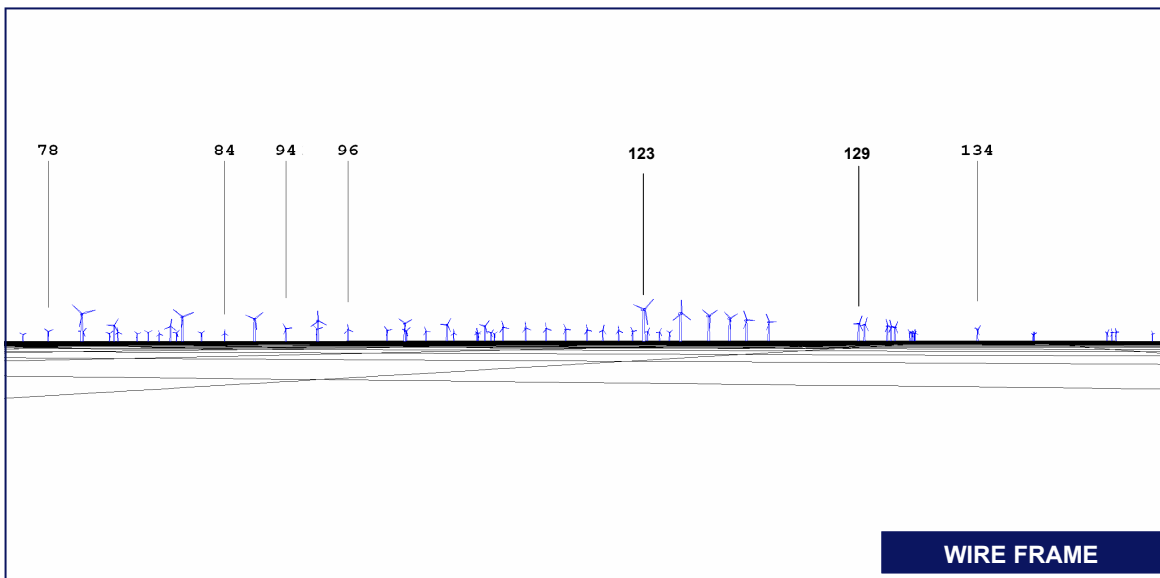

VISUAL SIMULATION



ORIGINAL PHOTO



WIRE FRAME

Note:
 * The Wire Frame Technical drawing does not take into consideration vegetation. It is possible that wind turbines are visible on the wire frame drawing but not on the visual simulation.

TECHNICAL DATA

PHOTOGRAPH - VIEW POINT

Photograph Number: IMG_0015
 Coordinates (UTM 14 NAD83): 610900 W 5437821 N
 Altitude with respect to mean sea level: 244 m
 Date Photograph was taken: May 1st, 2008
 Direction: 72 degree T.N.
 Focal Length: 41 mm
 View span: 50 degrees
 Altitude of photograph with respect to ground: 1.8 m

WIND TURBINES USED

Model: GE 1.5 sle
 Height of nacelle—mid point: 80 m
 Rotor Diameter: 77 m

SIMULATION

Visual Simulation No.: PM07-277_02STJO-IMG_15-E610900_N5437821-L20T02-D72-SD00.WFV
 Configuration No.: L20-277STJO(ALL)-20080520-SD.WFL
 Total number of wind turbines for the project: 200
 Total number of visible wind turbines in visual simulation: 12
 Closest visible wind turbine: No 123 at 3.2 km
 Furthest visible wind turbine: No 138 at 12.8 km

MAP

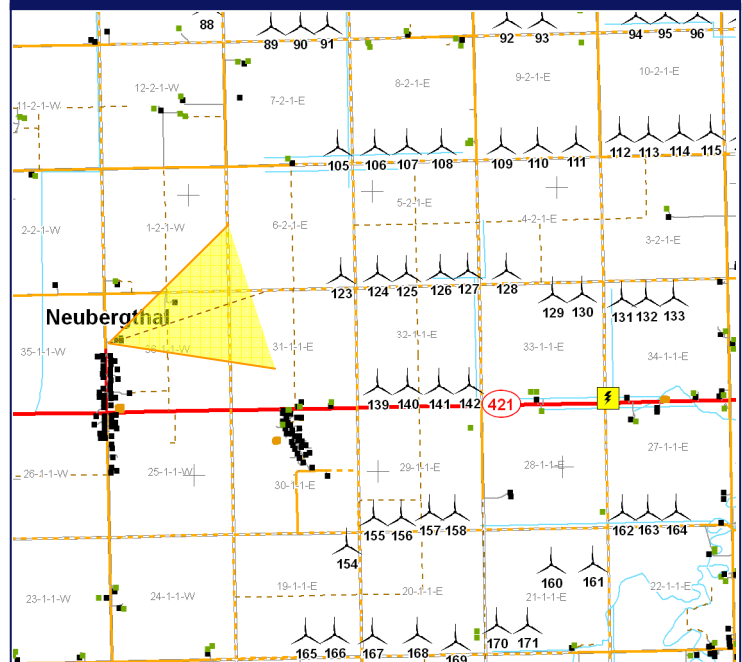

Prepared for:



Prepared by:



Date: June 2nd, 2008
 Version 02

VISUAL SIMULATION 7
View from Neubergthal Street Village Northern End (from the Church Parking Lot)

St. Joseph Wind Energy Project